

ON 1793

The Courses and Distances Down the river are as follows.

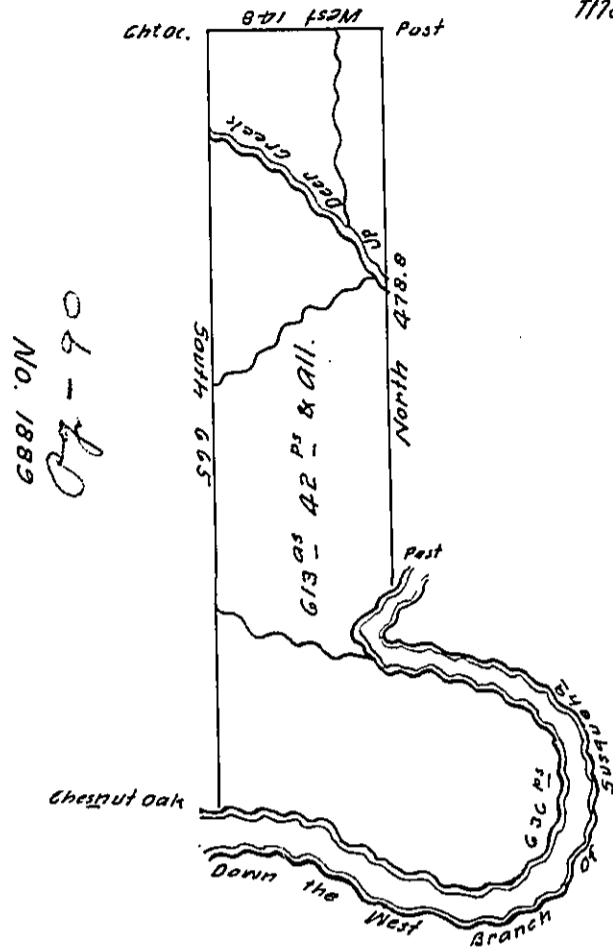

- N. 68 E. 47
- S. 68 E. 83
- S. 74 E. 71
- N. 67 E. 56
- N. 40 E. 31
- N. 3 W. 34
- N. 29 W. 22
- N. 57 W. 16
- N. 69 W 30
- West 100
- N. 40 W 42
- N. 19 E 36
- N. 54 E. 40
- N. 60 E. 28
- 636

Situate on the North side of the West branch of Susquehanna River, about half a mile above Deer Creek in Northd County. Containing 613 acres 42 perches and the usual allowance for Roads &c.

Surveyed July 11th 1793 for Robert Morris and Walter Stewart Esq^s in pursuance of a Warrant No. 3648 bearing date January 10th 1793.

Daniel Brodhead Esq^s S.G.

IN TESTIMONY that the above is a copy of the original remaining on file in the Department of Internal Affairs of Pennsylvania, made conformably to an Act of Assembly approved the 16th day of February, 1833, I have hereunto set my Hand and caused the Seal of said Department to be affixed at Harrisburg, this twenty sixth day of December 1905

Isaac B. Denny
Secretary of Internal Affairs.